

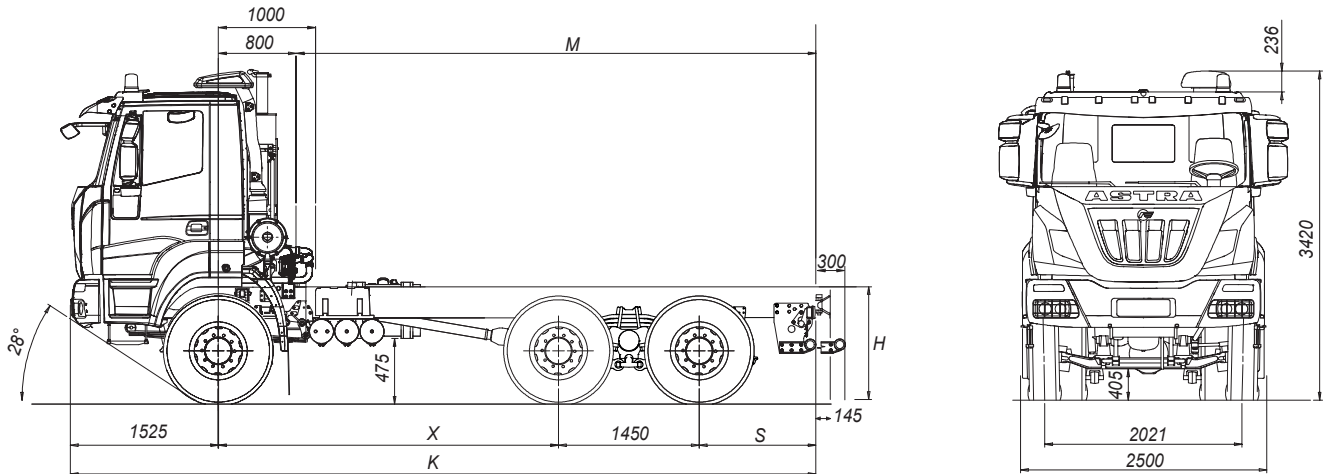

chassis-cab 6x6
66.38 / 66.42 / 66.44 / 66.48 / 66.54

DIMENSIONS (mm)

X	K	M max (*)	S	H		TURNING DIAMETER (WALL TO WALL)
				unloaded	loaded	
3500	7675	5350	1200	1252	1189	17960
3800	7975	5650	1200-1800	1252	1189	18910
4100	8275	5950	1200	1252	1189	19850
4500	8675	6350	1200-1900-2500-2600	1252	1189	21110
4750	9625	7300	1900	1252	1189	21910
5100	9975	7650	1200-1900	1252	1189	23020

(*) M max.: indicative value calculated in std configuration to be confirmed by bodybuilder.
 Vertical dimensions with standard tyres 13R 22.5

WEIGHTS (kg)

X	Distribution net weight (*)			Max technical weight			
	First axle	Rear axles	Net Weight	First axle	Rear axles	Gross Vehicle Weight	Gross Combination Weight
3500	5365	4935	10300	8000 9000 (1) 10000 (3)	32000 (2)	40000 (2)	56000 (4) 130000 (5)
3800	5410	4930	10340				
4100	5450	4920	10370				
4500	5500	4925	10425				
4750	5555	4950	10505				
5100	5655	4890	10545				

- (*) Weights are referred to standard configuration and include chassis cab (or tractor), driver (75 kg), full fuel tank, tools kit and spare wheel (if present).
- (1) With tyres on front axles 385/65R22.5 or 325/95R24 and reinforced springs (OPT).
 - (2) With tyres 325/95R24 or max speed limited to 70 Km/h depending on pneus type and brand.
 - (3) With Kessler front axle, 325/95R24 tyres and max speed limited to 70 km/h, depending on pneus type and brand.
 - (4) This value is valid only for ZF Ecosplit 4 manual gearbox. The combination weight is 90.000 kg for ZF As-Tronic automated gearbox and 60.000 kg for Traxon automated gearbox.
 - (5) For manual gearbox with additional parking brake air chambers. Exceptional charge < 5% of the time of use of the vehicle.

Characteristics and equipment are subject to changes without prior notice.
The data shown are indicative and non-binding.





ENGINES

CURSOR 13 turbo intercooler euro 3 diesel injection/cycle with electronic unit injection pumps. Single block head, four valves per cylinder, light alloy pistons. Total displacement: 12.882 cm³. Bore for stroke: 135x50 mm. 6 in-line cylinders. Water cooling. Dry air filter with safety cartridge. Vertical muffler.

	66.38	66.42	66.44	66.48	66.54
Model	Cursor 13				
Max power (EEC)	280 kW (380 HP)	309 kW (420 HP)	324 kW (440 HP)	353 kW (480 HP)	397 kW (540 HP)
Corresponding rpm	1900 rpm				
Max Torque (EEC)	1.800 Nm (183 kgm)	1.900 Nm (194 kgm)	2.100 Nm (214 kgm)	2.200 Nm (224 kgm)	2.350 Nm (240 kgm)
Turbine	WG (Waste Gate)		VGT (Variable Geometry Turbine)		



GEARBOX

Manual **ZF Ecosplit** 4 technology gearbox with servoshift, 16 synchronised forward speeds + 2 reverse. First/last speed ratio: 13.80/0.84.

On request:

Automated **ZF AS-Tronic**, 16 forward speeds + 2 reverse. First/last speed ratio: 14.12/0.83.

Automatic **ALLISON** transmission (wheelbase>4100mm). First/last speed ratio: 7.63/0.64.

Automated **ZF Traxon**, 12 forward speeds + 2 reverse. First/last speed ratio: 12.92/0.77.



CLUTCH

Single dry plate, diameter 17". Pull type engagement with diaphragm spring. Hydro- pneumatic power steering engagement control, with driven disc wear recovery slave cylinder.



TRANSFER BOX

Mechanical with two ratios. Helical spur gears, mounted on three propeller shafts, engaged with each other. Lockable differential by pneumatic control from driver seat. Transmission ratio 1:1 - 1:1,6. Front/rear torque distribution ratio 1:2,2.



AXLES

FRONT:

1st axle, driving and steering, in cast iron with double reduction, central by beveled pair, lateral by epicyclic group in wheel hubs.

On request: Lockable differential by pneumatic control from driver seat. Reinforced front axle max technical weight up to 9 ton with reinforced suspension and up to 10 ton with reinforced suspension and steering system. Available axle ratio: 5,01 - 5,47 - 5,96 - 6,28.

REAR:

Two drive axles in tandem. Double reduction: central with beveled pair, final in the wheel hubs by means of epicycloidal assembly. Torque distribution between the axles by means of a distributor fitted on the intermediate axle. Differential lockable from driver seat. Tandem assembled to the chassis by reaction rods with silentblocks.

On request: Rear-axle ratio 1:3.793 -1:4.229 -1:5.009 -1:5.558 -1:6.095 -1:6.588.



SUSPENSIONS

FRONT:

1st axle, parabolic springs, n° 4 leaves 24x90 mm, with hydraulic shock absorbers. Standard stabilizer bar.

On request: Reinforced parabolic springs, n° 5 leaves 24x90 mm.

REAR:

Parabolic springs, swivelling on central pin: n° 4 leaves 40x100 mm.

On request: Stabiliser bar on 2nd axle. Stabiliser bar on 3rd axle. Extra-reinforced conventional springs, n° 10 leaves 25x100 mm.



CHASSIS

Special steel with high tensile strength limit, two flat and parallel side members (width 820 mm.), C section (320x90x10mm), cross members bolted to the frame.

R.B.M. (Rail Bending Moment): 202.020 Nm (20.593 Kgm.). Steel front bumpers with headlamp protection grids, front maneuvering hook, rear underrun bar, steel fuel tank capacity 300 litres.



TYRES

FRONT: 13R22,5 156/150 G Single tubeless.

REAR: 13R22,5 156/150 G Twin tubeless.

Spare wheel on the chassis.

Other possible combinations:

315/80R22.5 156/150K

385/65R22.5 160J (*) + 315/80R22.5 156/150K

325/95R24 162/160K (*) (**)

(*) Mandatory with 9 ton front axle load.

(**) Mandatory with 10 ton front axle load.

Other tyres available, subject to the Astra technical office approval.



BRAKES

Front and rear "duo-duplex" self-adjusting wedge type brakes with automatic play take-up. Total net braking surface 9.276 cm². ABS + EBL system.

Service brake: Pedal controlled air brake, acting on all wheels.

Solo vehicles: two independent circuits, one for 1st axle, one for 2nd and 3rd axle.

Towing vehicles: three independent circuits, one for 1st axle, one for 2nd and 3rd axle and another for the trailer.

Emergency brake: Incorporated in service brake.

Parking brake: Mechanical spring-type with pneumatic control acting on 2nd and 3rd axle wheels.

IVECO BRAKE TURBO engine brake.

On request:

Hydraulic additional braking system on transmission (only for automated and automatic gearbox)

OFF/ROAD button for excluding ABS for speed 15 kph.



ELECTRICAL SYSTEM

Voltage: 24 V.

Alternator generator 90 A - 28 V (2520 W).

Accumulators: 2 in series, 180 Ah.

Starter motor 24 V 5,5 kW.

Mechanically controlled electrical circuit breaker.



CAB

White short cab built in galvanized pressed steel with hydraulic tilting up to 60°. Cab suspension with 4 helicoidal springs with coaxial shock absorbers and integrated dampers, anti-roll bar and end-of-stroke pads. Tinted electric door windows. Mechanical rear view mirrors, wide angle mirrors and front view mirror. Internal panels completely washable and fireproof. Compressed air quick coupling for cab cleaning. 4-speed ventilation and heating system with air recirculation system. Air suspended 3-way adjustable driver seat and mechanical passenger seat.